

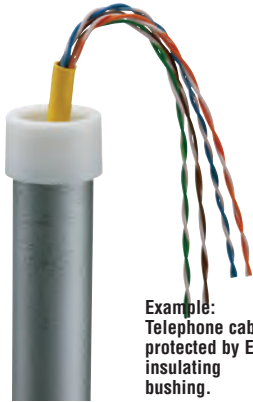

Insulating Bushings

Press fit. Holds firmly in place while pulling cables.



Example: Telephone cable protected by EMT insulating bushing.

| CATALOG NUMBER | UPC/DCI/NAED MFG #01 8997 | TRADE SIZE | UNIT PKG | STD PKG | DIM A | DIM B |
|----------------|---------------------------|------------|----------|---------|-------|-------|
| EMT50 | 12200 | 1/2 | 100 | 1000 | .531 | .840 |
| EMT75 | 12205 | 3/4 | 100 | 1000 | .531 | 1.056 |
| EMT100 | 12220 | 1 | 100 | 100 | .625 | 1.280 |
| EMT125 | 12225 | 1-1/4 | 100 | 100 | .625 | 1.660 |
| EMT150 | 12230 | 1-1/2 | 100 | 100 | .625 | 1.915 |
| EMT200 | 12235 | 2 | 50 | 50 | .625 | 2.377 |
| EMT250* | 12240 | 2-1/2 | 25 | 25 | 1.225 | 3.062 |
| EMT300* | 12245 | 3 | 25 | 25 | 1.225 | 3.690 |
| EMT350* | 12250 | 3-1/2 | 25 | 25 | 1.231 | 4.187 |
| EMT400* | 12255 | 4 | 25 | 25 | 1.233 | 4.815 |

Refer to page I-1 for Rigid Insulating Bushings size 1/2" through 4".

*Can also be used for rigid, IMC, and PVC rigid conduit.



E105706 LR49636

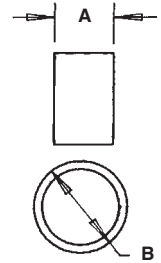

Arlington's EMT Insulating Bushings protect cables from abrasion by EMT. Examples: Power, Cable TV, computer datalines, telephone/modem, audio/video cables, alarm systems, security systems. EMT is often used to protect cables where damage could occur in a house or building.

Meets 2008 NEC code requirements for 300-15(c) protection. Listed for use in environmental air handling spaces per 2008 NEC code requirements 300-22(c).

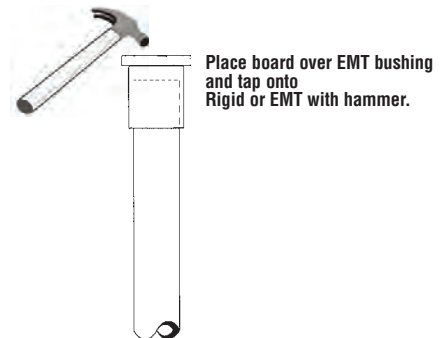
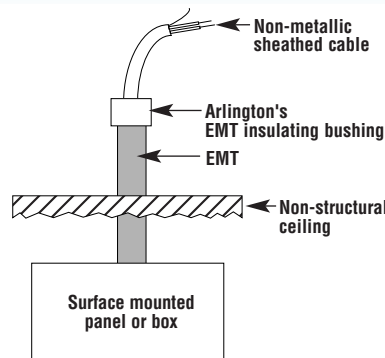

Place board over EMT bushing and tap onto Rigid or EMT with hammer.



Conduit Caps

Conduit cap and insulating bushing.



EMT50C



EMT75C

| CATALOG NUMBER | UPC/DCI/NAED MFG #01 8997 | TRADE SIZE | UNIT PKG | STD PKG | DIM A | DIM B |
|----------------|---------------------------|------------|----------|---------|-------|-------|
| EMT50C | 12203 | 1/2 | 100 | 1000 | .531 | .840 |
| EMT75C | 12204 | 3/4 | 100 | 1000 | .531 | 1.056 |
| EMT100C | 12207 | 1 | 100 | 100 | .625 | 1.280 |
| EMT125C | 12209 | 1-1/4 | 100 | 100 | .625 | 1.660 |
| EMT150C | 12211 | 1-1/2 | 100 | 100 | .625 | 1.915 |
| EMT200C | 12213 | 2 | 50 | 50 | .625 | 2.377 |
| EMT250C* | 12215 | 2-1/2 | 25 | 25 | 1.225 | 3.062 |
| EMT300C* | 12217 | 3 | 25 | 25 | 1.225 | 3.690 |
| EMT350C* | 12219 | 3-1/2 | 25 | 25 | 1.231 | 4.187 |
| EMT400C* | 12221 | 4 | 25 | 25 | 1.233 | 4.815 |

Refer to page I-1 for Rigid Insulating Bushings size 1/2" through 4".

*Can also be used for rigid, IMC, and PVC rigid conduit.



E105706 LR49636

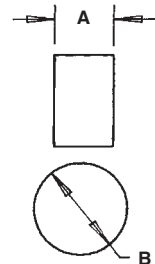

Use this capped version to seal off conduit during concrete pours. Then remove cap/seal with razor knife or use screwdriver to punch hole in cap. (EMT300C)

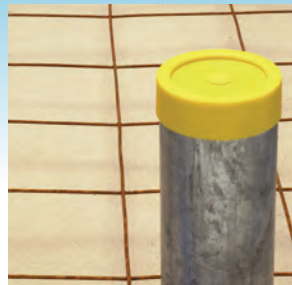

String can be used to aid removal.

EMT 2-Piece Connector

Zinc die-cast.



| CATALOG NUMBER | UPC/DCI/NAED MFG #01 8997 | TRADE SIZE | KO SIZE | UNIT PKG | STD PKG | DIM A | DIM B |
|----------------|---------------------------|------------|---------|----------|---------|-------|-------|
| L20 | 32000 | 1/2 | 1/2 | 50 | 250 | .770 | 1.107 |



E20643 LR49636

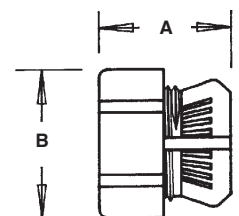



EMT Set-Screw Connectors

Concrete tight. Zinc die-cast.



800



803

| CATALOG NUMBER | UPC/DCI/NAED MFG #01 8997 | TRADE SIZE | KO SIZE | UNIT PKG | STD PKG | DIM A | DIM B | DIM C |
|----------------|---------------------------|------------|---------|----------|---------|-------|-------|-------|
| 800 | 00800 | 1/2 | 1/2 | 50 | 500 | 1.143 | .375 | 1.076 |
| 801 | 00801 | 3/4 | 3/4 | 25 | 250 | 1.390 | .350 | 1.300 |
| 802 | 00802 | 1 | 1 | 20 | 200 | 1.550 | .460 | 1.550 |
| 803 | 00803 | 1-1/4 | 1-1/4 | 10 | 60 | 1.930 | .636 | 1.935 |
| 804* | 00804 | 1-1/2 | 1-1/2 | 10 | 60 | 2.200 | .707 | 2.175 |
| 805* | 00805 | 2 | 2 | 5 | 30 | 2.535 | .750 | 2.650 |
| 806*† | 00806 | 2-1/2 | 2-1/2 | 12 | 12 | 2.930 | .830 | 3.300 |
| 807*† | 00807 | 3 | 3 | 12 | 12 | 3.330 | .930 | 3.910 |
| 8075*† | 08075 | 3-1/2 | 3-1/3 | 6 | 6 | 3.500 | 1.000 | 4.465 |
| 808*† | 00808 | 4 | 4 | 6 | 6 | 3.665 | 1.000 | 4.984 |

Add suffix "RH" for Robertson Head Screws.

*Concrete tight when taped.

†Listed for use with steel and aluminum EMT, IMC, and rigid conduit.



E20643 LR49636

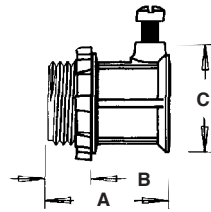

1/2" - 1"

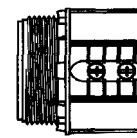

1-1/4" - 2"

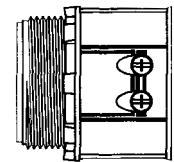

2-1/2" - 4"

EMT Set-Screw Connectors with Insulated Throat

Concrete tight. Zinc die-cast.



800A



803A

| CATALOG NUMBER | UPC/DCI/NAED MFG #01 8997 | TRADE SIZE | KO SIZE | UNIT PKG | STD PKG | DIM A | DIM B | DIM C |
|----------------|---------------------------|------------|---------|----------|---------|-------|-------|-------|
| 800A | 80010 | 1/2 | 1/2 | 50 | 500 | 1.240 | .470 | 1.076 |
| 801A | 80110 | 3/4 | 3/4 | 25 | 250 | 1.483 | .449 | 1.300 |
| 802A | 80210 | 1 | 1 | 20 | 100 | 1.643 | .550 | 1.550 |
| 803A | 80310 | 1-1/4 | 1-1/4 | 10 | 60 | 2.023 | .729 | 1.935 |
| 804A* | 80410 | 1-1/2 | 1-1/2 | 10 | 60 | 2.293 | .800 | 2.195 |
| 805A* | 80510 | 2 | 2 | 5 | 30 | 2.630 | .840 | 2.650 |
| 806A*† | 80610 | 2-1/2 | 2-1/2 | 12 | 12 | 3.030 | .920 | 3.280 |
| 807A*† | 80710 | 3 | 3 | 12 | 12 | 3.468 | 1.030 | 3.910 |
| 8075A*† | 80711 | 3-1/2 | 3-1/2 | 6 | 6 | 3.600 | 1.088 | 4.465 |
| 808A*† | 80810 | 4 | 4 | 6 | 6 | 3.758 | 1.100 | 4.984 |

Add suffix "RH" for Robertson Head Screws.

*Concrete tight when taped.

†Listed for use with steel and aluminum EMT, IMC, and rigid conduit.



E20643 LR49636

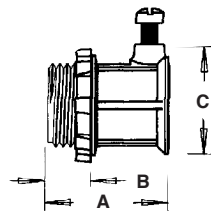

1/2" - 1"

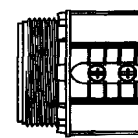

1-1/4" - 2"

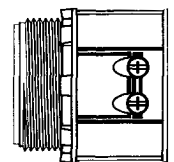

2-1/2" - 4"



EMT Set-Screw Couplings

Concrete tight. Zinc die-cast.



810



816

| CATALOG NUMBER | UPC/DCI/NAED MFG #01 8997 | TRADE SIZE | UNIT PKG | STD PKG | DIM A | DIM B |
|----------------|---------------------------|------------|----------|---------|-------|-------|
| 810 | 00810 | 1/2 | 50 | 500 | .950 | 1.560 |
| 811 | 00811 | 3/4 | 25 | 250 | 1.145 | 1.869 |
| 812 | 00812 | 1 | 15 | 150 | 1.435 | 2.000 |
| 813 | 00813 | 1-1/4 | 20 | 120 | 1.828 | 2.500 |
| 814* | 00814 | 1-1/2 | 10 | 60 | 2.075 | 2.890 |
| 815* | 00815 | 2 | 5 | 30 | 2.535 | 2.567 |
| 816*† | 00816 | 2-1/2 | 12 | 12 | 3.280 | 4.000 |
| 817*† | 00817 | 3 | 12 | 12 | 3.910 | 4.500 |
| 8175*† | 08175 | 3-1/2 | 6 | 6 | 4.460 | 4.814 |
| 818*† | 00818 | 4 | 6 | 6 | 4.984 | 5.269 |

Add suffix "RH" for Robertson Head Screws.

*Concrete tight when taped.

†Listed for use with steel and aluminum EMT, IMC, and rigid conduit.



E20643 LR49636

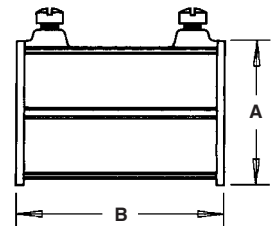

EMT Compression Couplings

UL listed concrete tight. CSA listed concrete tight/rain tight. Zinc die-cast.



830



836

| CATALOG NUMBER | UPC/DCI/NAED MFG #01 8997 | TRADE SIZE | UNIT PKG | STD PKG | DIM A | DIM B |
|----------------|---------------------------|------------|----------|---------|-------|-------|
| 830 | 00830 | 1/2 | 50 | 500 | 1.550 | 1.080 |
| 831 | 00831 | 3/4 | 25 | 250 | 1.615 | 1.313 |
| 832 | 00832 | 1 | 15 | 150 | 1.692 | 1.616 |
| 833 | 00833 | 1-1/4 | 10 | 100 | 2.160 | 2.080 |
| 834 | 00834 | 1-1/2 | 10 | 60 | 2.290 | 2.380 |
| 835 | 00835 | 2 | 10 | 60 | 2.600 | 2.910 |
| 836* | 00836 | 2-1/2 | 12 | 12 | 3.070 | 3.470 |
| 837* | 00837 | 3 | 12 | 12 | 3.300 | 4.133 |
| 838* | 00838 | 3-1/2 | 6 | 6 | 3.330 | 4.775 |
| 839* | 00839 | 4 | 6 | 6 | 3.445 | 5.300 |

*Listed for use with steel and aluminum EMT, IMC, and rigid conduit.



E20643 LR49636

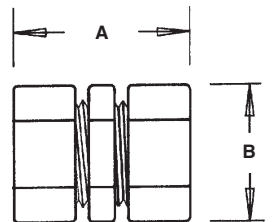



EMT Compression Connectors

UL listed concrete tight. CSA listed concrete tight. Zinc die-cast.



820



826

| CATALOG NUMBER | UPC/DCI/NAED MFG #01 8997 | TRADE SIZE | KO SIZE | UNIT PKG | STD PKG | DIM A | DIM B | DIM C |
|----------------|---------------------------|------------|---------|----------|---------|-------|-------|-------|
| 820 | 00820 | 1/2 | 1/2 | 50 | 500 | 1.235 | .349 | 1.080 |
| 821 | 00821 | 3/4 | 3/4 | 25 | 250 | 1.350 | .453 | 1.313 |
| 822 | 00822 | 1 | 1 | 15 | 60 | 1.525 | .538 | 1.616 |
| 823 | 00823 | 1-1/4 | 1-1/4 | 5 | 25 | 1.878 | .600 | 2.080 |
| 824 | 00824 | 1-1/2 | 1-1/2 | 10 | 100 | 2.020 | .607 | 2.380 |
| 825 | 00825 | 2 | 2 | 10 | 60 | 1.995 | .645 | 2.910 |
| 826* | 00826 | 2-1/2 | 2-1/2 | 12 | 12 | 2.775 | .860 | 3.470 |
| 827* | 00827 | 3 | 3 | 12 | 12 | 2.847 | .998 | 4.133 |
| 828* | 00828 | 3-1/2 | 3-1/2 | 6 | 6 | 2.800 | .998 | 4.775 |
| 829* | 00829 | 4 | 4 | 6 | 6 | 3.000 | 1.007 | 5.300 |

*Listed for use with steel and aluminum EMT, IMC, and rigid conduit.



E20643 LR49636

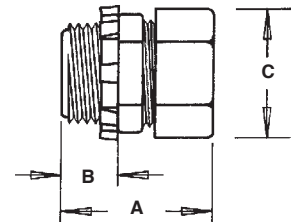

EMT Compression Connectors with Insulated Throat

UL listed concrete tight. CSA listed concrete tight. Zinc die-cast.



820A



826A

| CATALOG NUMBER | UPC/DCI/NAED MFG #01 8997 | TRADE SIZE | KO SIZE | UNIT PKG | STD PKG | DIM A | DIM B | DIM C |
|----------------|---------------------------|------------|---------|----------|---------|-------|-------|-------|
| 820A | 82010 | 1/2 | 1/2 | 50 | 500 | 1.346 | .442 | 1.080 |
| 821A | 82110 | 3/4 | 3/4 | 25 | 250 | 1.443 | .546 | 1.313 |
| 822A | 82210 | 1 | 1 | 15 | 60 | 1.620 | .631 | 1.616 |
| 823A | 82310 | 1-1/4 | 1-1/4 | 5 | 25 | 1.971 | .693 | 2.080 |
| 824A | 82410 | 1-1/2 | 1-1/2 | 10 | 100 | 2.120 | .700 | 2.380 |
| 825A | 82510 | 2 | 2 | 10 | 60 | 2.088 | .738 | 2.910 |
| 826A* | 82610 | 2-1/2 | 2-1/2 | 12 | 12 | 2.870 | .953 | 3.470 |
| 827A* | 82710 | 3 | 3 | 12 | 12 | 2.940 | 1.091 | 4.133 |
| 828A* | 82810 | 3-1/2 | 3-1/2 | 6 | 6 | 2.900 | 1.091 | 4.775 |
| 829A* | 82910 | 4 | 4 | 6 | 6 | 3.150 | 1.100 | 5.300 |

*Listed for use with steel and aluminum EMT, IMC, and rigid conduit.



E20643 LR49636

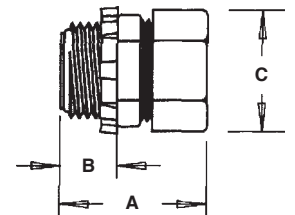



**EMT Rain Tight
Compression
Connectors**

UL listed rain tight and concrete tight. Steel. Blue compression nuts help identify these products as raintight.



| CATALOG NUMBER | UPC/DCI/NAED MFG #01 8997 | TRADE SIZE | KO SIZE | UNIT PKG | STD PKG | DIM A | DIM B | DIM C |
|----------------|---------------------------|------------|---------|----------|---------|-------|-------|-------|
| 820RT | 82020 | 1/2 | 1/2 | 50 | 50 | 1.608 | .437 | 1.125 |
| 821RT | 82021 | 3/4 | 3/4 | 50 | 50 | 1.657 | .437 | 1.375 |
| 822RT | 82022 | 1 | 1 | 25 | 25 | 1.823 | .500 | 1.688 |
| 823RT | 82023 | 1-1/4 | 1-1/4 | 10 | 10 | 2.103 | .625 | 2.063 |
| 824RT | 82024 | 1-1/2 | 1-1/2 | 10 | 10 | 2.191 | .625 | 2.250 |
| 825RT | 82025 | 2 | 2 | 10 | 10 | 2.298 | .688 | 2.750 |
| 826RT | 83005 | 2-1/2 | 2-1/2 | 12 | 12 | 3.548 | .750 | 3.625 |
| 827RT | 83006 | 3 | 3 | 12 | 12 | 3.628 | .875 | 4.250 |
| 828RT | 83007 | 3-1/2 | 3-1/2 | 6 | 6 | 3.834 | .937 | 4.688 |
| 829RT | 83008 | 4 | 4 | 6 | 6 | 4.135 | .937 | 5.188 |

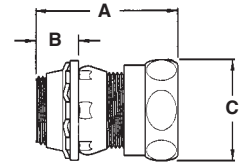

**EMT Rain Tight
Compression
Connectors with
Insulated Throat**

UL listed rain tight and concrete tight. Steel. Blue compression nuts help identify these products as raintight.



| CATALOG NUMBER | UPC/DCI/NAED MFG #01 8997 | TRADE SIZE | KO SIZE | UNIT PKG | STD PKG | DIM A | DIM B | DIM C |
|----------------|---------------------------|------------|---------|----------|---------|-------|-------|-------|
| 820ART | 82045 | 1/2 | 1/2 | 50 | 50 | 1.670 | .500 | 1.125 |
| 821ART | 82046 | 3/4 | 3/4 | 50 | 50 | 1.719 | .500 | 1.375 |
| 822ART | 82047 | 1 | 1 | 25 | 25 | 1.885 | .563 | 1.688 |
| 823ART | 82048 | 1-1/4 | 1-1/4 | 10 | 10 | 2.166 | .688 | 2.063 |
| 824ART | 82049 | 1-1/2 | 1-1/2 | 10 | 10 | 2.253 | .688 | 2.250 |
| 825ART | 82050 | 2 | 2 | 10 | 10 | 2.360 | .750 | 2.750 |
| 826ART | 83000 | 2-1/2 | 2-1/2 | 12 | 12 | 3.610 | .813 | 3.625 |
| 827ART | 83001 | 3 | 3 | 12 | 12 | 3.690 | .938 | 4.250 |
| 828ART | 83002 | 3-1/2 | 3-1/2 | 6 | 6 | 3.896 | 1.000 | 4.688 |
| 829ART | 83003 | 4 | 4 | 6 | 6 | 4.197 | 1.000 | 5.188 |

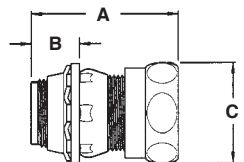

**EMT Rain Tight
Compression
Couplings**

UL listed rain tight and concrete tight. Steel. Blue compression nuts help identify these products as raintight.



| CATALOG NUMBER | UPC/DCI/NAED MFG #01 8997 | TRADE SIZE | UNIT PKG | STD PKG | DIM A | DIM B |
|----------------|---------------------------|------------|----------|---------|-------|-------|
| 830RT | 82030 | 1/2 | 50 | 50 | 1.890 | 1.125 |
| 831RT | 82031 | 3/4 | 50 | 50 | 2.052 | 1.375 |
| 832RT | 82032 | 1 | 25 | 25 | 2.219 | 1.688 |
| 833RT | 82033 | 1-1/4 | 10 | 10 | 2.558 | 2.063 |
| 834RT | 82034 | 1-1/2 | 10 | 10 | 2.587 | 2.250 |
| 835RT | 82035 | 2 | 10 | 10 | 2.746 | 2.750 |
| 836RT | 00865 | 2-1/2 | 12 | 12 | 4.207 | 3.625 |
| 837RT | 00866 | 3 | 12 | 12 | 4.500 | 4.250 |
| 838RT | 00867 | 3-1/2 | 6 | 6 | 5.025 | 4.688 |
| 839RT | 00868 | 4 | 6 | 6 | 5.460 | 5.188 |

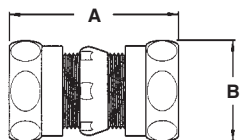



**Combination
Threaded Rigid
and Set-Screw EMT**

90° pulling elbows with cover and gasket. Zinc die-cast.



| CATALOG NUMBER | UPC/DCI/NAED MFG #01 8997 | TRADE SIZE | UNIT PKG | STD PKG | DIM A | DIM B |
|----------------|---------------------------|------------|----------|---------|-------|-------|
| HL5000 | 83105 | 1/2 | 10 | 100 | 2.150 | 2.150 |
| HL7500 | 83175 | 3/4 | 5 | 50 | 2.300 | 2.300 |
| HL100 | 50171 | 1 | 5 | 25 | 3.040 | 3.040 |
| HL125 | 50173 | 1-1/4 | 2 | 10 | 3.900 | 3.900 |

See hub illustration below.

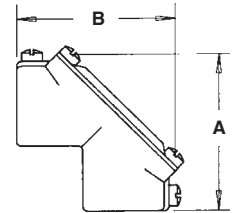

**Combination
Threaded Rigid
and Set-Screw
EMT To Box**

90° pulling elbows with cover and gasket. Zinc die-cast.



| CATALOG NUMBER | UPC/DCI/NAED MFG #01 8997 | TRADE SIZE | UNIT PKG | STD PKG | DIM A | DIM B |
|----------------|---------------------------|------------|----------|---------|-------|-------|
| 9100 | 91005 | 1/2 | 5 | 50 | 2.030 | 1.945 |
| 9110 | 91100 | 3/4 | 5 | 50 | 2.260 | 2.140 |
| 9120 | 50165 | 1 | 5 | 25 | 2.610 | 2.610 |
| 9130 | 50167 | 1-1/4 | 2 | 10 | 3.037 | 3.037 |

See hub illustration below.

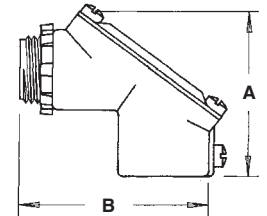

Hub Illustration

For Combination Threaded and Set-Screw Pull Elbows

Arlington's combination hubs are threaded for rigid and include set-screws for EMT. The set-screws may be used for rigid, but are not necessary. They are listed rain tight with rigid and concrete tight when taped for EMT. These products can also be used for EMT to rigid.





Combination Couplings

EMT to Flex. Zinc die-cast.



| CATALOG NUMBER | UPC/DCI/NAED MFG #01 8997 | EMT SIZE | FLEX SIZE | UNIT PKG | STD PKG | DIM A | DIM B | CABLE RANGE |
|----------------|---------------------------|----------|-----------|----------|---------|-------|-------|-------------|
| 860* | 00860 | 1/2 | 3/8 | 50 | 500 | 1.300 | 1.156 | .530-.620 |
| 861 | 00861 | 1/2 | 1/2 | 25 | 250 | 1.645 | 1.363 | .850-.910 |
| 862 | 00862 | 3/4 | 3/4 | 25 | 100 | 1.975 | 1.553 | 1.100-1.130 |

*CSA only.



E60812 LR49636

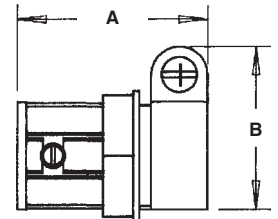

Combination Couplings

EMT set-screw to Flex. Zinc die-cast.



8600



8610

| CATALOG NUMBER | UPC/DCI/NAED MFG #01 8997 | EMT SIZE | FLEX SIZE | UNIT PKG | STD PKG | DIM A | DIM B | CABLE RANGE |
|----------------|---------------------------|----------|-----------|----------|---------|-------|-------|-------------|
| 8600* | 08600 | 1/2 | 3/8 | 50 | 500 | 1.162 | 1.090 | .530-.620 |
| 8610 | 08610 | 1/2 | 1/2 | 50 | 500 | 1.736 | 1.170 | .850-.910 |
| 8620 | 08620 | 3/4 | 3/4 | 25 | 100 | 1.934 | 1.360 | 1.100-1.130 |
| 8630 | 08630 | 1 | 1 | 10 | 40 | 2.290 | 1.625 | 1.255-1.375 |

*CSA only.



E60812 LR49636

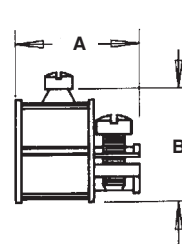

8600

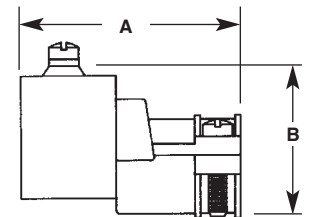

8610-8630

Combination Couplings

EMT compression to screw-in flexible metal conduit. Zinc die-cast.



| CATALOG NUMBER | UPC/DCI/NAED MFG #01 8997 | EMT SIZE | FLEX SIZE | UNIT PKG | STD PKG | DIM A | DIM B | DIM C | DIM D |
|----------------|---------------------------|----------|-----------|----------|---------|-------|-------|-------|-------|
| GF860 | 76860 | 1/2 | 3/8 | 25 | 100 | 1.504 | .445 | .725 | 1.060 |
| GF861 | 76861 | 1/2 | 1/2 | 25 | 250 | 1.345 | .715 | .725 | 1.060 |
| GF862 | 76862 | 3/4 | 3/4 | 25 | 250 | 1.745 | .946 | .950 | 1.305 |
| GF863 | 80173 | 1 | 1 | 25 | 100 | 1.895 | 1.125 | 1.170 | 1.625 |
| GF864 | 80175 | 1-1/4 | 1-1/4 | 10 | 40 | 2.500 | 1.420 | 1.340 | 2.100 |



E60812 LR49636

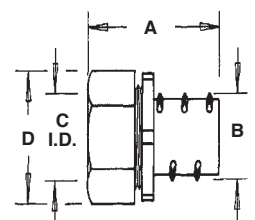



Heavy-Duty 1-Hole EMT Straps

Plated steel, Click-on.



| CATALOG NUMBER | UPC/DCI/NAED MFG #01 8997 | TRADE SIZE | UNIT PKG | STD PKG | DIM A | DIM B | DIM C | DIM D |
|----------------|---------------------------|------------|----------|---------|-------|-------|-------|-------|
| 370 | 00370 | 1/2 | 100 | 1000 | 1.700 | .700 | .562 | .250 |
| 371 | 00371 | 3/4 | 100 | 1000 | 1.935 | .975 | .625 | .250 |
| 372 | 00372 | 1 | 50 | 500 | 2.210 | 1.090 | .750 | .312 |
| 373 | 00373 | 1-1/4 | 25 | 250 | 2.800 | 1.540 | .875 | .375 |
| 374 | 00374 | 1-1/2 | 25 | 100 | 3.140 | 1.790 | 1.000 | .375 |
| 375 | 00375 | 2 | 25 | 100 | 3.890 | 2.150 | 1.125 | .437 |
| 346 | 00346 | 2-1/2 | 25 | 25 | 4.927 | 2.958 | 1.250 | .562 |
| 347 | 00347 | 3 | 25 | 25 | 5.560 | 3.441 | 1.250 | .562 |
| 348 | 00348 | 3-1/2 | 10 | 10 | 6.337 | 3.951 | 1.250 | .562 |
| 349 | 00349 | 4 | 10 | 10 | 6.811 | 4.441 | 1.250 | .562 |



E186443 LR104691

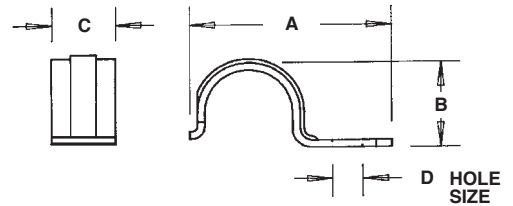

2-Hole EMT Straps

Plated steel, Click-on.



| CATALOG NUMBER | UPC/DCI/NAED MFG #01 8997 | TRADE SIZE | UNIT PKG | STD PKG | DIM A | DIM B | DIM C | DIM D |
|----------------|---------------------------|------------|----------|---------|-------|-------|-------|-------|
| 360 | 00360 | 1/2 | 100 | 1000 | 2.200 | .790 | .562 | .187 |
| 361 | 00361 | 3/4 | 50 | 500 | 2.700 | .980 | .625 | .187 |
| 362 | 00362 | 1 | 50 | 250 | 2.975 | 1.185 | .688 | .187 |
| 363 | 00363 | 1-1/4 | 50 | 250 | 3.650 | 1.535 | .750 | .258 |
| 364 | 00364 | 1-1/2 | 25 | 250 | 4.250 | 1.670 | .875 | .258 |
| 365 | 00365 | 2 | 25 | 250 | 4.775 | 2.300 | 1.000 | .375 |
| 356 | 00356 | 2-1/2 | 25 | 100 | 5.850 | 2.855 | 1.000 | .375 |
| 357 | 00357 | 3 | 25 | 25 | 6.460 | 3.425 | 1.000 | .375 |
| 358 | 00358 | 3-1/2 | 10 | 10 | 7.300 | 3.925 | 1.000 | .375 |
| 359 | 00359 | 4 | 10 | 10 | 7.895 | 4.390 | 1.000 | .375 |

